

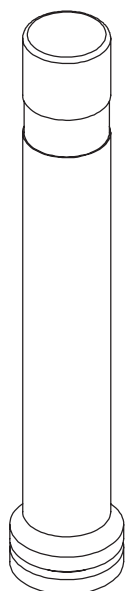

INSTALLATION EXAMPLE

A-FLEX / A-ECO REMOVABLE BASE BOLLARD

● INCLUDES:



x 1 ut.
Bollard \varnothing 95 mm.

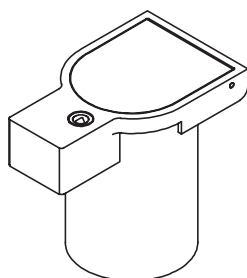

x 1 ut.
Removable base



x 1 ut.
Key

● INSTALLATION:

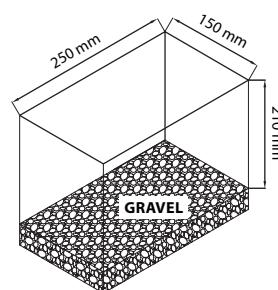

EXISTING SOIL

1.

Perform a hole for the bollard installation. Preferably with diamond bit drill, if it is not possible to use jackhammer or rotary. Make a gravel drainage.

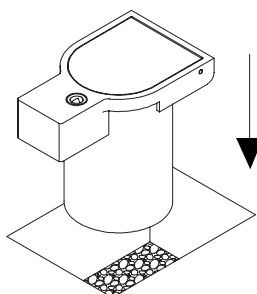

2.

Put the removable base.

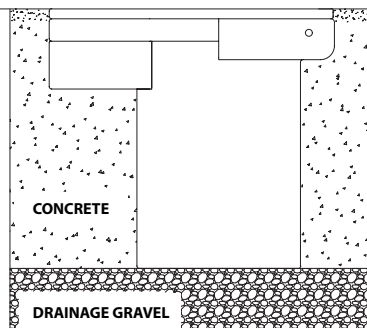

3.

Fill the hole with concrete.

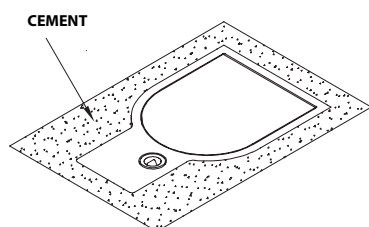

EXISTING SOIL

4.

Level and fix the base correctly with cement.

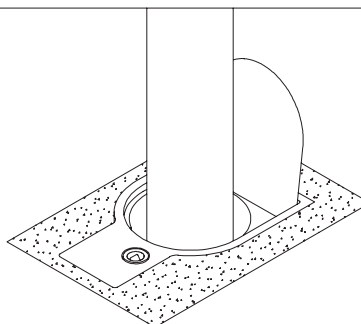

EXISTING SOIL

5.

Open the base with key and insert the bollard.



www.adourbanfurniture.com



+34 93 116 29 75 (International) | +34 93 456 03 03 (Spanish)



info@adourbanfurniture.com