

ADO  
design



Ref. BLEYENDG01

**SIZE:**

Width: 730 mm.

Total height: 850 mm.

Length: 1812 mm.

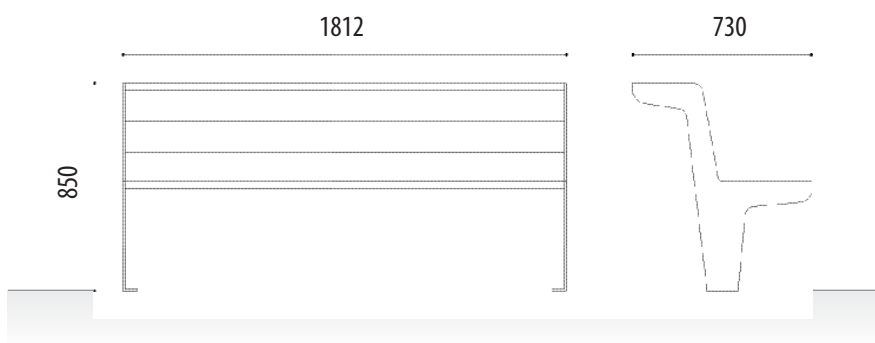

**Leyend urban bench** composed of eight 1800x110x35 mm tropical wood slats (3+3+2)

Structure manufactured from 8 mm laser cut metal sheet.

Designed with simple anchor system to facilitate assembly and economise shipping.

Ideal for municipalities, shopping centres, schools, squares, streets, parks, etc...

**STANDARD FINISHES:**

Oxiron grey. . . . . Ref. BLEYENDG01

**OPTIONAL:**

- Possibility of synthetic wood slats.
- Possibility of steel slats.
- Possible manufacture in faux weathering or other colours.



Wood

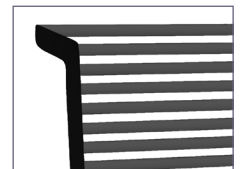

Tube



Flat sheet

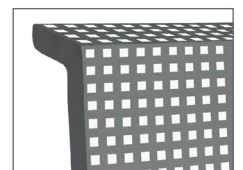

Perforated sheet

*The bench is supplied unassembled in order to facilitate its transportation.*

ADO  
design



Ref. SLEYENDG01

**SIZE:**

Width: 730 mm.  
Height: 850 mm.  
Length: 612 mm.

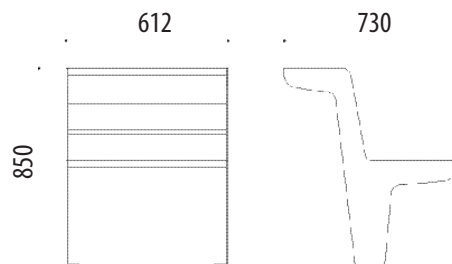

**Leyend single-seat bench** composed of eight 1800x110x35 mm tropical wood slats (3+3+2)

Structure manufactured from 8 mm laser cut metal sheet.

Designed with simple anchor system to facilitate assembly and economise shipping.

Ideal for municipalities, shopping centres, schools, squares, streets, parks, etc...

**STANDARD FINISHES:**

Oxiron grey. . . . . Ref. SLEYENDG01

**OPTIONAL:**

- Possibility of synthetic wood slats.
- Possibility of steel slats.
- Possible manufacture in faux weathering or other colours.



Wood

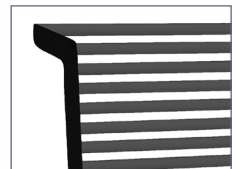

Tube



Flat sheet

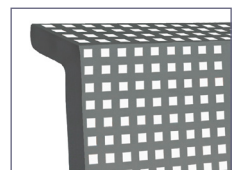

Perforated sheet